

500 KVA STANDBY SILENCED SET VOLVO

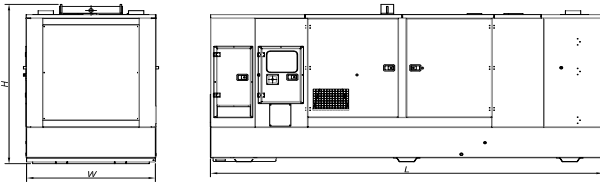

TECHNICAL INFORMATION

Voltage (V):	400/230
Frequency (Hz):	50
PRP Power (kVA)	455
Standby Power (kVA)	506
PRP Power (kW)	364
Standby Power (kW)	406

Weight and Dimensions (mm)

Length (L)	4580
Width (W)	1500
Height (H)	2235
Weight (kg)	4757
Fuel tank capacity (l)	590

Noise Level

Acoustic Pressure [LpA] (dBA @7m)	70
Acoustic Power [LwA] (Dba)	97

Consumption

	PRP Power	
	L/h	Range (hours)
25%	25.4	23.2
50%	46.6	12.7
75%	69.2	8.5
100%	91.8	6.4

	Standby Power	
	L/h	Range (hours)
25%	27.4	21.5
50%	51.4	11.5
75%	76.7	7.7
100%	101.7	5.8

ENGINE

Brand	VOLVO
Model	TAD 1345 GE
Electronic Management	YES
No. of cylinders	6
Engine Capacity (c.c)	12780
Bore (mm)	131
Stroke (mm)	158
Compression ratio	18.1:1
Water cooled	YES
Speed (R.P.M)	1500
Mechanical Net Power (kWm)	431
Fuel tank capacity (l)	590

Cooling System

Flow of air from fan (m3/min)	402
Water Jacket Heater	YES

Lubrication System

Oil sump capacity (l)	36
Maximum oil consumption (% fuel consumption)	0.4

Air intake system

Aspirated air flow (m3/min)	27.6
-----------------------------	------

Electrical System

Number of batteries	2
Battery	12V 44Ah-730A

Exhaust System

Input diameter (")	6
Output diameter (")	7.6
Body diameter (mm)	611
Exhaust length (mm)	1.350
T° gas emission (°C)	570
Gas flow (m3/min)	58.3

ALTERNATOR

Model	LSA 47.2 S5
Electronic Regulation	YES
AVR	R 450
Power (kVA)	500

ELECTRIC PANEL

Protection Devices	YES
Control Card	DEEP SEA 7320