

500 KVA STANDBY SILENCED SET MTU

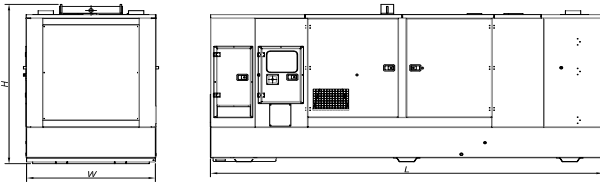

TECHNICAL INFORMATION

Voltage (V):	400/230
Frequency (Hz):	50
PRP Power (kVA)	455
Standby Power (kVA)	500
PRP Power (kW)	364
Standby Power (kW)	400

Weight and Dimensions (mm)

Length (L)	5000
Width (W)	1650
Height (H)	2300
Weight (kg)	5927
Fuel tank capacity (l)	685

Noise Level

Acoustic Pressure [LpA] (dBA @7m)	71
Acoustic Power [LwA] (Dba)	98

Consumption

	PRP Power	
	L/h	Range (hours)
25%	29.4	23.3
50%	56	12.2
75%	81.2	8.4
100%	102.9	6.7

	Standby Power	
	L/h	Range (hours)
25%	32	21.4
50%	61.4	11.2
75%	87.4	7.8
100%	110.2	6.2

ENGINE

Brand	MTU
Model	10V 1600 G10/70
Electronic Management	YES
No. of cylinders	10
Engine Capacity (c.c)	17500
Bore (mm)	122
Stroke (mm)	150
Compression ratio	17.5:1
Water cooled	YES
Speed (R.P.M)	1500
Mechanical Net Power (kWm)	430.3
Fuel tank capacity (l)	685

Cooling System

Flow of air from fan (m3/min)	654
-------------------------------	-----

Lubrication System

Oil sump capacity (l)	53
Maximum oil consumption (% fuel consumption)	0.5

Air intake system

Aspirated air flow (m3/min)	27
-----------------------------	----

Electrical System

Number of batteries	2
Battery	12V 44Ah-730A

Exhaust System

Input diameter (")	6
Output diameter (")	7.6
Body diameter (mm)	611
Exhaust length (mm)	1.350
T ^a gas emission (°C)	520
Gas flow (m3/min)	75

ALTERNATOR

Model	LSA 47.2 S5
AVR	R 450
Power (kVA)	500

ELECTRIC PANEL

Protection Devices	YES
Control Card	DEEP SEA 7320