

400 KVA STANDBY SILENCED SET MTU

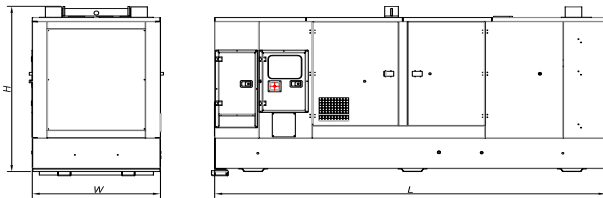

TECHNICAL INFORMATION

| | |
|---------------------|---------|
| Voltage (V): | 400/230 |
| Frequency (Hz): | 50 |
| PRP Power (kVA) | 365 |
| Standby Power (kVA) | 405 |
| PRP Power (kW) | 292 |
| Standby Power (kW) | 324 |

Weight and Dimensions (mm)

| | |
|------------------------|------|
| Length (L) | 4580 |
| Width (W) | 1500 |
| Height (H) | 2235 |
| Weight (kg) | 4878 |
| Fuel tank capacity (l) | 590 |

Noise Level

| | |
|-----------------------------------|----|
| Acoustic Pressure [LpA] (dBA @7m) | 70 |
| Acoustic Power [LwA] (Dba) | 97 |

Consumption

| | PRP Power | |
|------|-----------|---------------|
| | L/h | Range (hours) |
| 25% | 26.1 | 22.6 |
| 50% | 44.7 | 13.2 |
| 75% | 62.2 | 9.5 |
| 100% | 80.3 | 7.3 |

| | Standby Power | |
|------|---------------|---------------|
| | L/h | Range (hours) |
| 25% | 27.4 | 21.5 |
| 50% | 48.6 | 12.1 |
| 75% | 68.5 | 8.6 |
| 100% | 86.8 | 6.8 |

ENGINE

| | |
|----------------------------|----------------|
| Brand | MTU |
| Model | 8V 1600 G10/70 |
| Electronic Management | YES |
| No. of cylinders | 8 |
| Engine Capacity (c.c) | 14000 |
| Bore (mm) | 122 |
| Stroke (mm) | 150 |
| Compression ratio | 17.5:1 |
| Water cooled | YES |
| Speed (R.P.M) | 1500 |
| Mechanical Net Power (kWm) | 348.4 |
| Fuel tank capacity (l) | 590 |

Cooling System

| | |
|-------------------------------|-----|
| Flow of air from fan (m3/min) | 390 |
| Water Jacket Heater | YES |

Lubrication System

| | |
|--|-----|
| Oil sump capacity (l) | 43 |
| Maximum oil consumption (% fuel consumption) | 0.5 |

Air intake system

| | |
|-----------------------------|------|
| Aspirated air flow (m3/min) | 21.6 |
|-----------------------------|------|

Electrical System

| | |
|---------------------|---------------|
| Number of batteries | 2 |
| Battery | 12V 44Ah-730A |

Exhaust System

| | |
|----------------------|-----|
| Input diameter (") | 4 |
| Output diameter (") | 5.5 |
| Body diameter (mm) | 453 |
| T° gas emission (°C) | 549 |
| Gas flow (m3/min) | 60 |

ALTERNATOR

| | |
|-----------------------|--------------|
| Model | LSA 47.2 VS2 |
| Electronic Regulation | YES |
| AVR | R 450 |
| Power (kVA) | 420 |

ELECTRIC PANEL

| | |
|--------------------|---------------|
| Protection Devices | YES |
| Control Card | DEEP SEA 7320 |