

# 560 KVA STANDBY SILENCED SET PERKINS

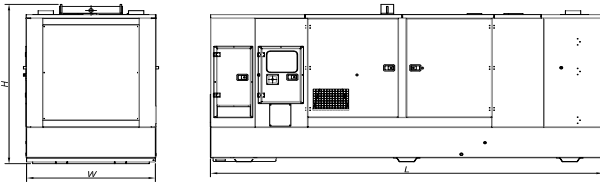

## TECHNICAL INFORMATION

Voltage (V):	400/230
Frequency (Hz):	50
PRP Power (kVA)	500
Standby Power (kVA)	561.7
PRP Power (kW)	400
Standby Power (kW)	449.3

## Weight and Dimensions (mm)

Length (L)	5000
Width (W)	1650
Height (H)	2300
Weight (kg)	5443
Fuel tank capacity (l)	995

## Noise Level

Acoustic Pressure [LpA] (dBA @7m)	71
Acoustic Power [LwA] (Dba)	98

## Consumption

	PRP Power	
	L/h	Range (hours)
25%	0	0
50%	54.1	18.4
75%	77.2	12.9
100%	101.9	9.8

	Standby Power	
	L/h	Range (hours)
25%	0	0
50%	0	0
75%	84.7	11.7
100%	112.4	8.9

## ENGINE

Brand	PERKINS
Model	2506A-E15TAG2
Electronic Management	YES
No. of cylinders	6
Engine Capacity (c.c)	15200
Bore (mm)	137
Stroke (mm)	171
Compression ratio	16:1
Water cooled	YES
Speed (R.P.M)	1500
Mechanical Net Power (kWm)	478
Fuel tank capacity (l)	995

## Cooling System

Flow of air from fan (m3/min)	576
-------------------------------	-----

## Lubrication System

Oil sump capacity (l)	62
Maximum oil consumption (% fuel consumption)	0.1

## Air intake system

Aspirated air flow (m3/min)	36.6
-----------------------------	------

## Electrical System

Number of batteries	2
Battery	12V 44Ah-730A

## Exhaust System

Input diameter (")	6
Output diameter (")	7.6
Body diameter (mm)	611
Exhaust length (mm)	1.350
T <sup>a</sup> gas emission (°C)	550
Gas flow (m3/min)	98

## ALTERNATOR

Model	LSA 47.2 M7
Electronic Regulation	YES
AVR	R 450
Power (kVA)	570

## ELECTRIC PANEL

Protection Devices	YES
Control Card	DEEP SEA 7320